

Light Tape®

Electro-LuminX®



Backlighting made easy with Light Tape®

With spring in the air, we look for ideas to refresh our living space, and the most popular room at this time of year is the kitchen. Whether it's a DIY project or a complete renovation, Light Tape® is the solution to give any kitchen that WOW factor.



TESTING YOUR SURFACE

Is the surface really translucent? To decipher this, we have a light surface test that we recommend you try to make sure Light Tape® is a good fit for your surface, as not every surface has the same level of translucency.

WHAT WE WILL NEED

A top view layout of the area you are looking to backlight. This layout can be hand drawn or a PDF with the dimensions broken out. We want to see how the surface is laid out; is the area an L Shape, or does it have a curve, and are there any cutouts for a sink and faucet? We can cut Light Tape® to any shape with holes for fittings, and basically send you a 'light gasket' to match your surface.

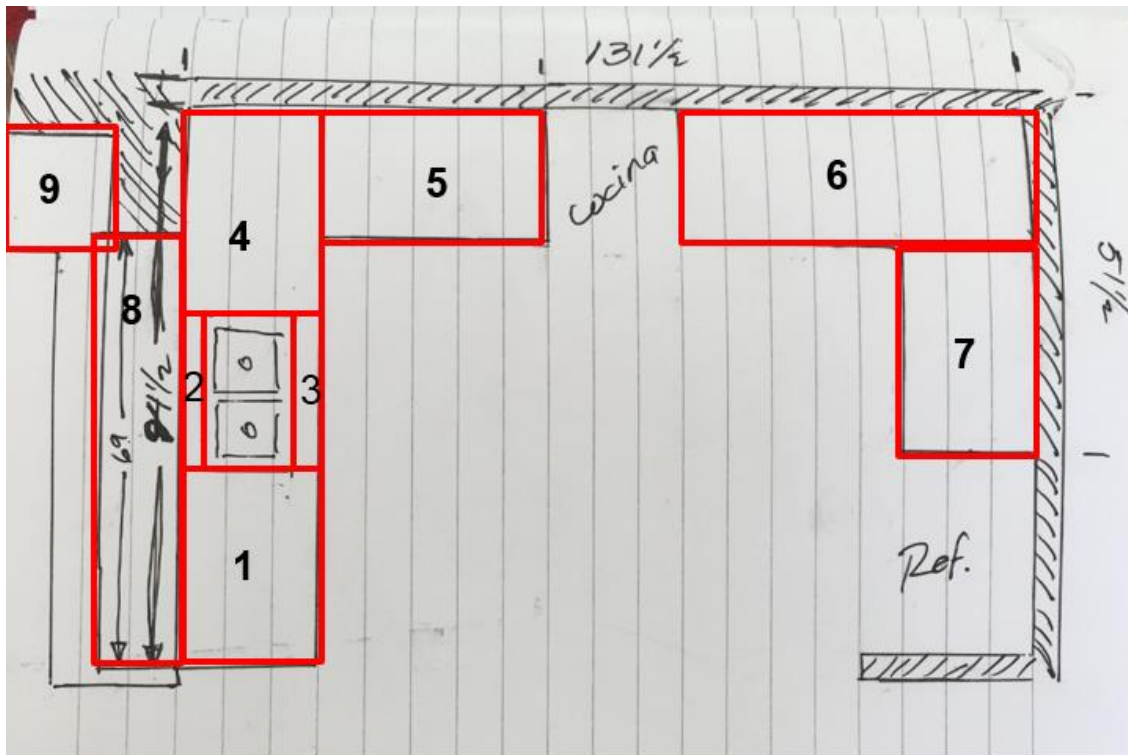

INSTALLING

We recommend you adhere Light Tape® to your subsurface with double sided adhesive tape, and then place the surface directly on top. Yes, Light Tape® can withstand the weight of your surface! Our extensions tabs are designed to position the electrical connection under the mounting surface and out of the way. Our Smart Diver™ power supplies have remote dimming capabilities and can accept either an AC (110/220 VAC) or DC (12V or 24V) input.

Whether it's one or multiple pieces you are installing, we will walk you through the installation.

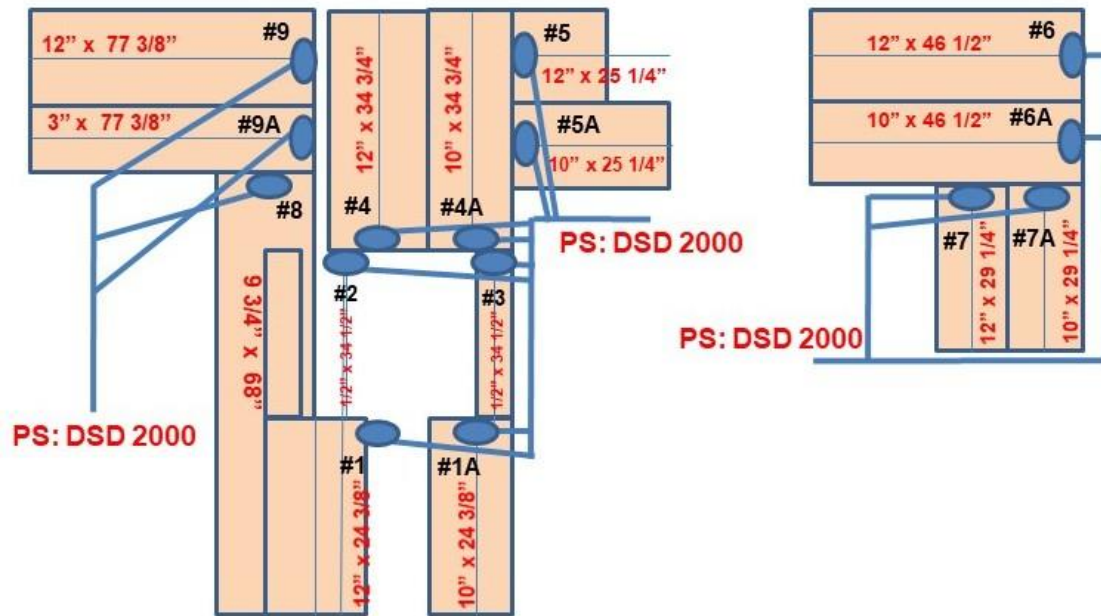

● Connection points

[LEARN MORE](#)

Stop by and visit us at NeoCon in Chicago on June 11-13th at booth 7-5014.

We really like you. We hope you like us, too!



[Facebook](#)



[Twitter](#)



[YouTube](#)



[Instagram](#)



[Pinterest](#)

Copyright © 2018 Light Tape® by Electro-LuminX® Lighting Corp., All rights reserved.

1320 N. Boulevard, Richmond, VA 23230

www.lighttape.com

Want to change how you receive these emails?

You can [update your preferences](#) or [unsubscribe from this list](#)
